

**XG-Scale**

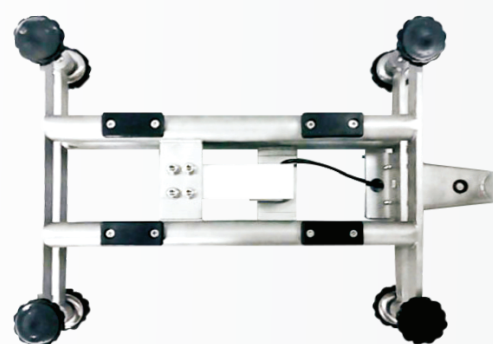

**rinstrum**

SMART WEIGHING SOLUTIONS



## XG Scale Base Series

- Aluminium load cell
- Stainless steel (304) frame/pan/post
- Various Scale capacities
- Different Pan sizes

## Scale Types

Type	Pan Dimensions	Max capacity
S	300x300 mm	15-150 kg
M	300x400 mm	15-150 kg
L	400x500 mm	30-300 kg
XL	500x600 mm	60-300 kg

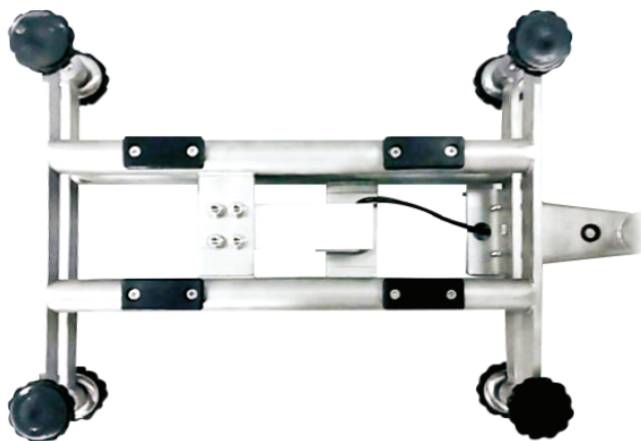

## Easy Maintenance & Operation

- Clear open frame – Easy to keep clean
- Removable low sided pan - Deflect splatter
- Sturdy pan construction – No warping
- 2 Axis rotating head – For best operator viewing angle

## Built To Last

- 2mm circular 304 stainless tubal steel
- Over load protection stops
- Rectangular folded pan
- Overload recording increments every time the scale is overloaded



## Proven Rinstrum Indicators

Choose the Rinstrum indicator that best suits your application from the basic R320 with weight only display through to filling on the R423 stainless steel for use in more complex operations.



### R320 Indicator

- ABS Housing with silicon keys
- AC/DC/ 4AA Battery Power Options
- Super low cost option weight display only
- Clock calendar, printing available depending on firmware



### X320 Indicator

- Tough enclosure – Impact resistant composite alloy housing
- IP68 and IP69K rated
- AC/DC/Battery Power Options
- 3 band check weighing



### R400 series indicator

- Stainless Steel or ABS housing
- Range of firmware options from basic printing to batching
- AC/DC/Battery Power Options
- Operator friendly with multiline display and alpha numeric keypad

### 300 x 300 (S)

300 x 300 mm stainless steel platform, tubular frame and IP65 sealed aluminum load cell, 36-38 cm stainless steel pole included. With maximum capacity of 150 kg.

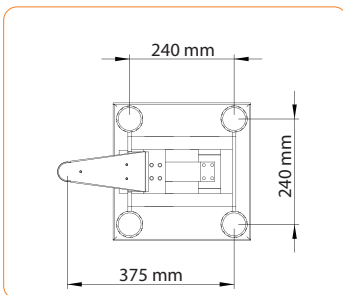
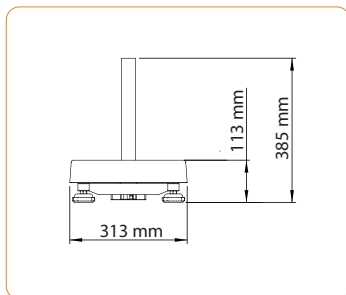
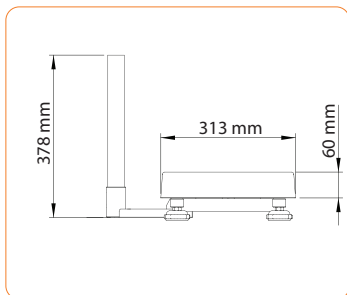

### 300 x 400 (M)

300 X 400 mm stainless steel platform, tubular frame and IP65 sealed aluminum load cell, 36-38 cm stainless steel pole included. With maximum capacity of 150 kg.

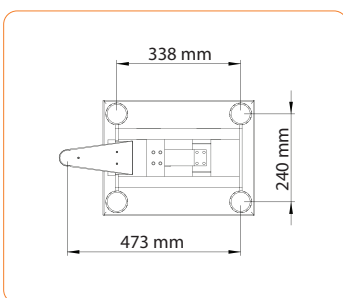
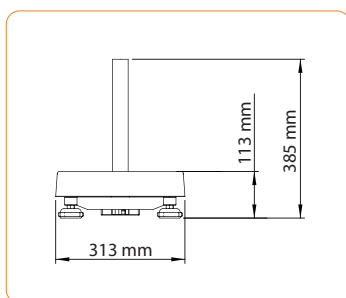
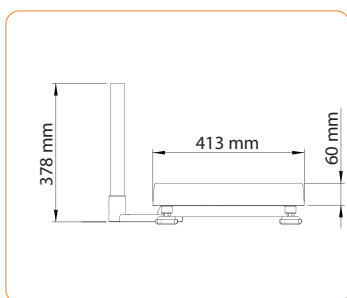

### 400 x 500 (L)

400 X 500 mm stainless steel platform, frame and IP65 sealed aluminum load cell, 66-68 cm stainless steel pole included. With maximum capacity of 300 kg.

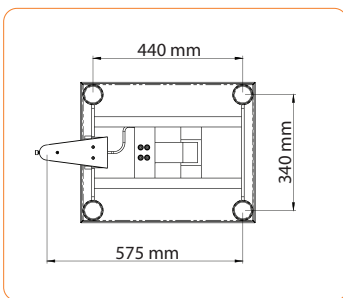
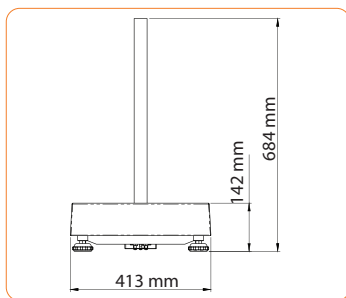
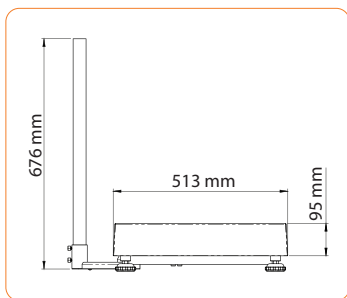

### 500 x 600 (XL)

500 x 600 mm stainless steel platform, tubular frame and IP65 sealed aluminum load cell, 66-68 cm stainless steel pole included. With maximum capacity of 300 kg.

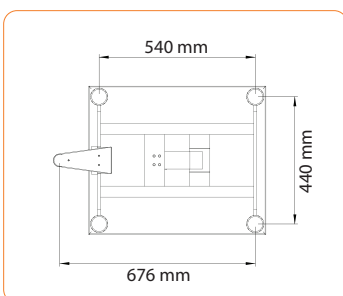
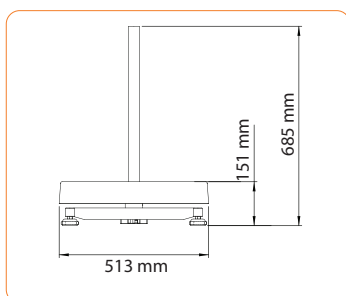
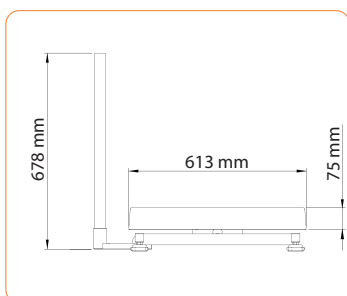

## Specifications

Load Cell IP Rating	IP65				
Approval	NMI: 6/4C/256				
Builds	Capacity x Resolution	300 x 300 (S)	300 x 400 (M)	400 x 500 (L)	500 x 600 (XL)
	15 kg x 0.005 kg	✓	✓	-	-
	30 kg x 0.01 kg	✓	✓	✓	-
	60 kg x 0.02 kg	✓	✓	✓	✓
	150 kg x 0.05 kg	✓	✓	✓	✓
	300 kg x 0.1 kg	-	-	✓	✓
Materials					
Frame	304 Stainless Steel				
Pan	304 Stainless Steel				
Feet	304 Stainless Steel				
Load cell	Aluminium				

## Firmware Specifications

Firmware	R400 Series		R300 Series	X300 Series
Functions	Basic (K401, K402)	Filling/Batching (K410/K411)	<b>K342 :</b> Basic weight only	<b>K376 :</b> Basic weighing + programmable function key + Basic check weighing + printing.
	1/250 Products Custom printing, custom unit switching, counting, manual hold, peak hold, auto output totalising	1/250 Products Custom printing, custom unit switching, counting, manual hold, peak hold, auto output totalising	<b>K344 :</b> Basic weighing + RS232 + Basic printing	<b>K378:</b> Basic weighing + function key fixed to check weighing + advanced check weighing + printing
			<b>K346 :</b> Basic weighing + RS232 + Basic printing + Set points	
			<b>K354 :</b> Basic weighing + RS232 + Custom printing + Clock	
			<b>K356 :</b> Basic weighing + RS232 + Custom printing + Clock + I/O + Set points	



### AUSTRALIA

Rinstrum Pty Ltd  
Unit 4/31 Henry Street  
Loganholme  
QLD 4129  
Australia

Ph: +61 7 3216 7166  
Email: sales.au@rinstrum.com

### USA

Rinstrum Inc  
1349 Piedmont Drive  
Troy, Michigan 48083  
United States

Toll Free 1 877 829 9152  
Ph: +1 248 680 0320  
Fax: +1 248 499 1331  
Email: sales.us@rinstrum.com

### EUROPE

Rinstrum Europe GmbH  
Hans-Böckler-Straße 42  
D-40764 Langenfeld  
Germany

Ph: +49 (0)2173 16562-10  
Fax: +49 (0)2173 16562-29  
Email: sales.eu@rinstrum.com